



NATIONAL
COUNCIL
for Mental
Wellbeing

CoE-IHS Office Hour: Telehealth in Rural Integrated Care

Tuesday, July 11, 2023

2-3pm ET

CENTER OF EXCELLENCE for Integrated Health Solutions

Funded by Substance Abuse and Mental Health Services Administration and operated by the National Council for Mental Wellbeing

Questions, Comments & Closed Captioning

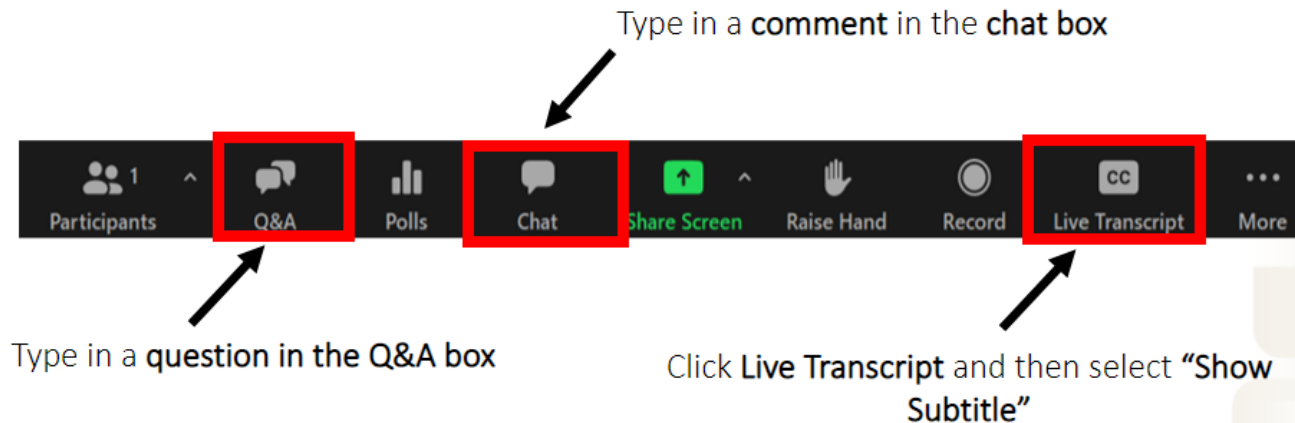

Disclaimer

The views, opinions, and content expressed in this presentation do not necessarily reflect the views, opinions, or policies of the Center for Mental Health Services (CMHS), the Substance Abuse and Mental Health Services Administration (SAMHSA), or the U.S. Department of Health and Human Services (HHS).



NATIONAL
COUNCIL
for Mental
Wellbeing

Today's Speakers

Moderator

- **Carolyn Rekerdres, MD**, Medical Director of NE Region, East Texas Behavioral Health Network

Panelist

- **Sirene Garcia, MSM**, *Chief Innovation Officer*, Finger Lakes Community Health
- **Daniel Gutierrez, MD**, *Chief Medical Officer*, Tropical Texas Behavioral Health

NATIONAL
COUNCIL
for Mental
Wellbeing



Rural, frontier and tribal communities are often excluded when policies, research and programs are designed at the federal and state levels. This lack of perspective can and has led to negative consequences in health systems and further exacerbating racial, economic, and gender-based disparities for individuals and communities living with mental health and/or substance use challenges.

In this session, we'll reflect on and discuss topics covered throughout the webinar series, including structural urbanism and leveraging telehealth services for youth, migrants and immigrant communities in rural areas.

Telehealth in Rural Integrated Care

NATIONAL
COUNCIL
for Mental
Wellbeing

Tools & Resources

- National Council for Mental Wellbeing- [Rural Interest Group](#)
- [Workforce Innovations in Integrated Care](#)
- [New Study: Behavioral Health Workforce Shortages will Negatively Impact Society](#)
- [Integrated Approaches to Improving Rural Health Equity and Access](#)
- [Rural Health Information Hub](#)
- [American Communities Project](#)
- [Telehealth Services: Rural Health Fact Sheet Series](#)
- [Workforce Capacity for Reducing Rural Disparities in Public Mental Health Services for Adults with Severe Mental Illness](#)
- [Turning COVID-19 Challenges into Opportunities: Tele-Behavioral Health within Latino Communities](#)

NATIONAL
COUNCIL
for Mental
Wellbeing

Previous Sessions

Sessions from the Telehealth in Rural Integrated Care Series

- [Part 1: Leveraging Telehealth to Improve Access & Reach in Rural Integrated Care](#)- April 2023 [slides & recording]
- [Part 2: Rural Telehealth for Youth in Schools and Beyond](#)- May 2023 [slides & recording]
- [Part 3 – Rural Telehealth and M-Health for Immigrants and Migrants](#)- June 2023 [slides & recording]

Other Related Sessions

- [Rural Health Part 1: Addressing Structural Urbanism in Rural Communities through Integrated Care](#)
- [Rural Health Part 2: Strategies for Recruiting and Retaining a Strong Rural Health Workforce](#)
- [CoE Office Hour: Rural Health Challenges During COVID-19](#)
- [CoE Office Hour: Resources & Tools for Advancing Rural Health Equity through Integrated Care](#)



Upcoming CoE Events

CoE-IHS Webinar: Integrated Care for Aging Populations

[Register for the Webinar](#) on Thursday, July 13th from 2-3pm ET

CoE-IHS Office Hour: Integrated Care for Aging Populations

[Register for the Office Hour](#) on Tuesday, July 18th from 1-2pm ET

Interested in an individual consultation with the CoE experts on integrated care?

[Contact us through this form here!](#)

Looking for free trainings and credits?

[Check out integrated health trainings from Relias here](#)

Subscribe for Center of Excellence Updates

[Subscribe here](#)

NATIONAL
COUNCIL
for Mental
Wellbeing

Thank You

Questions?

Email integration@thenationalcouncil.org

SAMHSA's Mission is to reduce the impact of substance abuse and mental illness on America's communities.

www.samhsa.gov

1-877-SAMHSA-7 (1-877-726-4727) 1-800-487-4889
(TDD)

NATIONAL
COUNCIL
*for Mental
Wellbeing*